

THESE BUILDING PLANS ARE ISSUED
 VIDE LETTER NO-EO/GMADN DATED 18/12/25
 3744

Technically Approved
 (From Town Planning Point of View)
 Vide Letter No. 15
 DTP(S)/.....Dated.....09/01/2026

Estate Officer (H)
 GMADA, S.A.S. Nagar

District Town Planner, S.A.S. Nagar

TERRACE FLOOR DOORS WINDOWS SCHEDULE				
S.NO	CODE	SIZE IN MM	CILL LVL IN MM	LINTELLVL. IN MM
1	FD3	1200X2400	-	2400
2	W3	1200X2300	100	2400

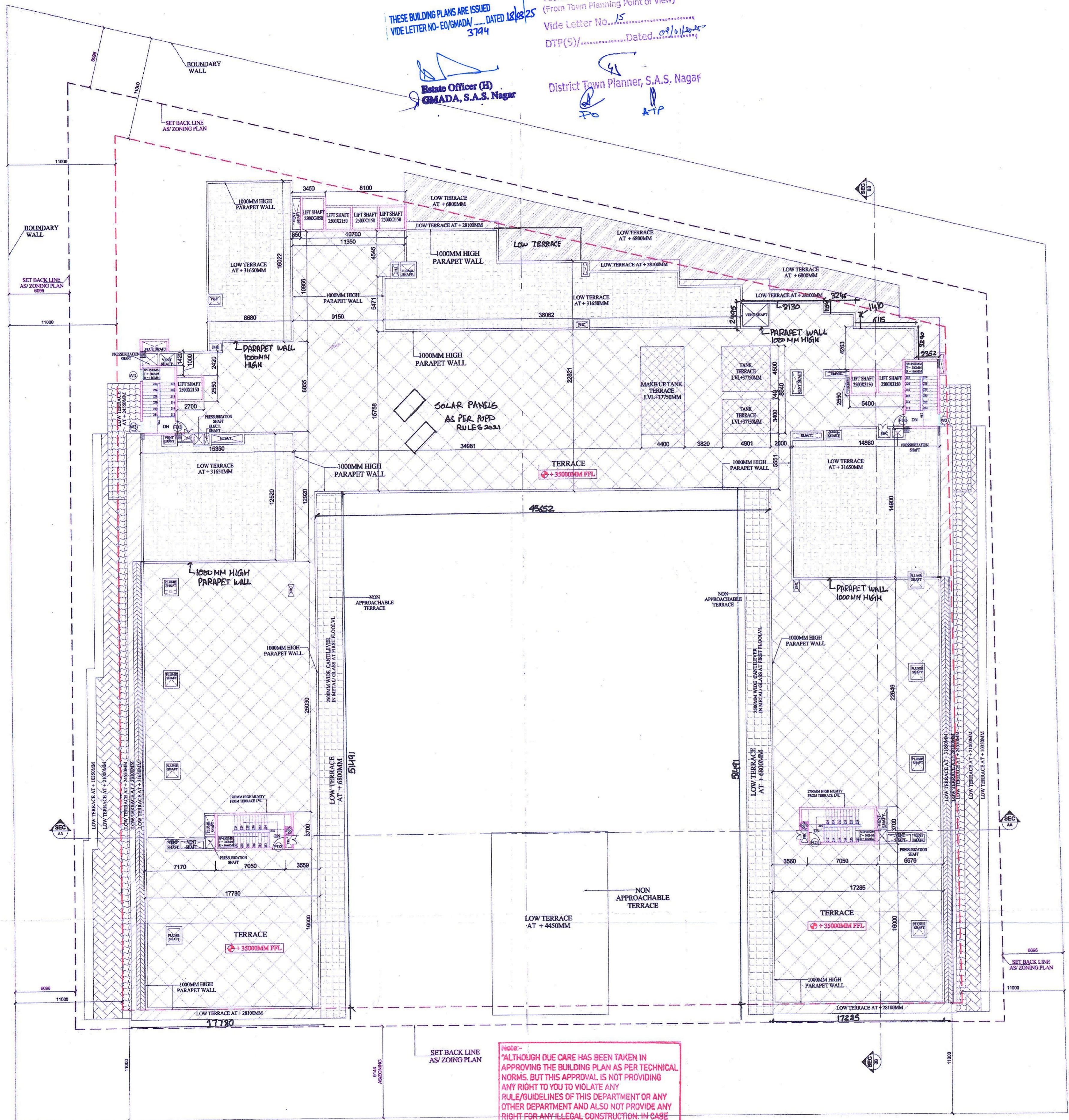

NOTE:-
 "ALTHOUGH DUE CARE HAS BEEN TAKEN IN APPROVING THE BUILDING PLAN AS PER TECHNICAL NORMS, BUT THIS APPROVAL IS NOT PROVIDING ANY RIGHT TO YOU TO VIOLATE ANY RULE/GUIDELINES OF THIS DEPARTMENT OR ANY OTHER DEPARTMENT AND ALSO NOT PROVIDE ANY RIGHT FOR ANY ILLEGAL CONSTRUCTION. IN CASE ANY VIOLATION FOUND AT ANY STAGE, YOU SHALL BE LIABLE TO GET THE BUILDING PLAN REVISED ACCORDINGLY IMMEDIATELY. THE APPROVAL IS SUBJECT TO DECISION OF ANY COURT CASE PREVAILING IN ANY HONBLE COURT OF LAW. IF ANY"

NOTE:-
 1. BUILDING IS FULLY SPRINKLERS AND FULLY MECHANICALLY VENTILATED, ARTIFICIALLY LIFTED WITH 100% POWER BACKUP AS PER NBC NORMS
 2. ALL RAILINGS ARE 1000MM IN HEIGHT.

CYBER SQUARE
 SITE NO 1 & II SHOPPING COMPLEX
 PHASE - IX EXPANSION INDUSTRIAL
 FOCAL POINT SAS NAGAR MOHALI

OWNERS SIGNATURE: *[Signature]* ARCHITECT'S SIGNATURE: *[Signature]*

NAVNEET SARIN
 CA NO. CA/90113498
 (REG. NO. 13498)

DRAWING TITLE: TERRACE FLOOR PLAN DATE: 28.12.2024

DRAWING NUMBER: A-25 SCALE: 1:200